

Česká republika

## Moravský zemský archiv v Brně

Palachovo nám. 1  
625 00 Brno

ČR - Moravský zemský archiv v Brně  
Palachovo nám. 1,  
625 00 Brno

Phone: + 420 533 317 574  
Fax: + 420 533 317 575  
E-mail: [podatelna@mza.cz](mailto:podatelna@mza.cz)

### GENEALOGICAL RESEARCH REQUEST FORM

Fill in this form and return by email or postmail to the address above. Use one form per individual or topic to be researched. All identifying data that you submit on this form will remain private.

**Your Name:** .....  
Your Address: .....  
City: ..... Country: .....  
ZIP/Postal Code: ..... E-mail: .....

#### Information about person to be researched:

Name (first and last): .....

Date of Birth, Marriage, Death: .....

Place of Birth, Marriage, Death:.....

Further Identification of the Locality (District, County, Parish or larger Town nearby):

.....

Father: .....

Mother: ..... Mother's Maiden Name: .....

Religion.....

Any other information you can provide: .....

.....

#### Relatives of the Ancestor (optional)

Name and Relationship:	Date of Birth/Marriage/Death	Place:
------------------------	------------------------------	--------

.....

.....

#### PLEASE MARK YOUR REQUESTED SCOPE OF RESEARCH:

Direct Male Line       Direct Male Line with Siblings

#### Requested Records:

Birth/Baptism       Marriage       Death

Special Requests: .....

I also request:       paper copies       digital copies      of the records:

.....

.....

If you have any family documents relating to this matter, please enclose copies of them.

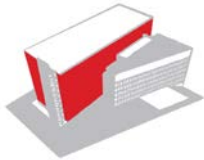
**Extract from the List of Service and Copying Fees Applicable in  
Moravian Provincial Archives in Brno**

issued based on Section 40 paragraph 5, of Act No 499/2004 Coll., on the Archives and Records Management and on amendments to certain laws, as amended, and related laws and in accordance with the Section 40 paragraph 7 of the same Act and Section 17 paragraph 1 and paragraph 2 of decree No 645/2004 Coll. as amended and related laws.

**B. 1. Reproduction of document - Electrographic copying (CZK/1 page of reproduction)**

	<b>Black and white, single-sided:</b>	<b>A4</b>	<b>A3</b>
1.1.1.2.	Bound originals	7,- CZK	12,- CZK
	<b>Colour single-sided:</b>		
1.2.1.2.	Bound originals	33,- CZK	46,- CZK

**3.3. Provision of digital reproduction of already digitalised original**

1 picture	Provision of digital reproduction of already digitalised original	25,- CZK
-----------	---	----------

**3.5. Recording of data**

3.5.1.	CD including recording of data	40,- CZK
3.5.2.	DVD including recording of data	60,- CZK

**D. 1. Written Research**

1. 1.	Written research processing (per hour)	300,- CZK
-------	--	-----------

**D. 2. Additional processing and handling charges**

1.1.	Additional processing (per hour)	60,- CZK
2.1.	Handling and packaging (an envelope up to 1 kg)	20,- CZK
2.2.	Handling and packaging (package over 1 kg)	30,- CZK
3.1.	Postage (Shipping) is charged according to the valid price list of The Czech Post.	

My limit on research costs – charges is:..... CZK.

Goods will be delivered after payment. Payment options – bank transfer. The charges of payer's bank as well as charges of the correspondent banks and beneficiary's bank are paid by the payer. We do not accept checks!

Date: ..... Signature: .....